

OEM Inquiries are welcome!

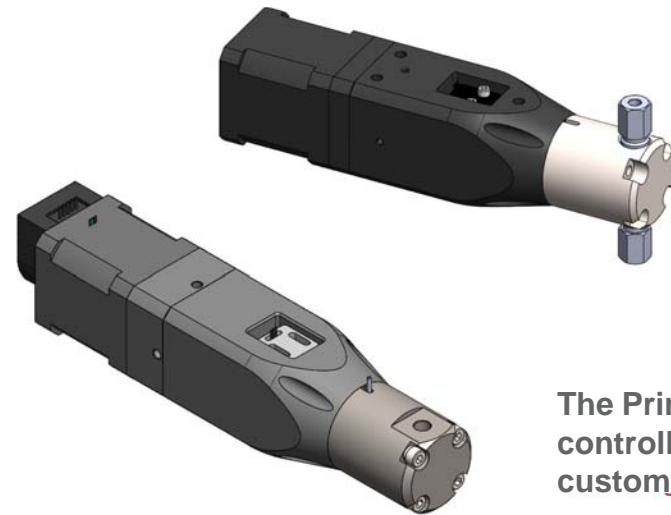

Standard Check Valve Configuration

The PrimeLine Syringe Pump without integral drive/controller for stepper motor, check valves or other custom features are available, please contact us.

Single Port and Encorder options

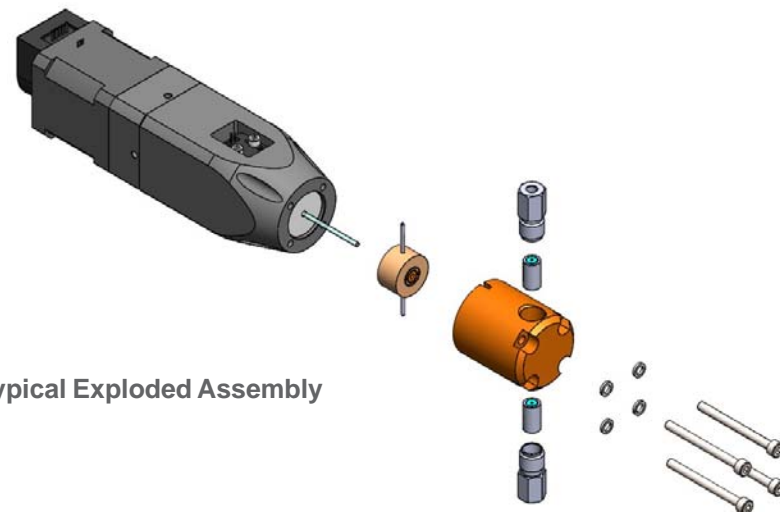

Typical Exploded Assembly

Analytical Scientific Instruments US, Inc.
3023 Research Drive Richmond CA 94806 USA
www.hplc-asi.com Phone: 510-669-2250 info@hplc-asi.com

ASI Analytical Scientific Instruments US

Copyright © 2014 ASI - Analytical Scientific Instruments US, Inc.
Rev.2_17_2025

PrimeLine™ Syringe Pumps

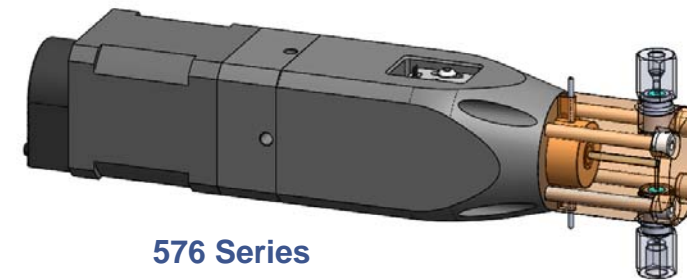

576 Series

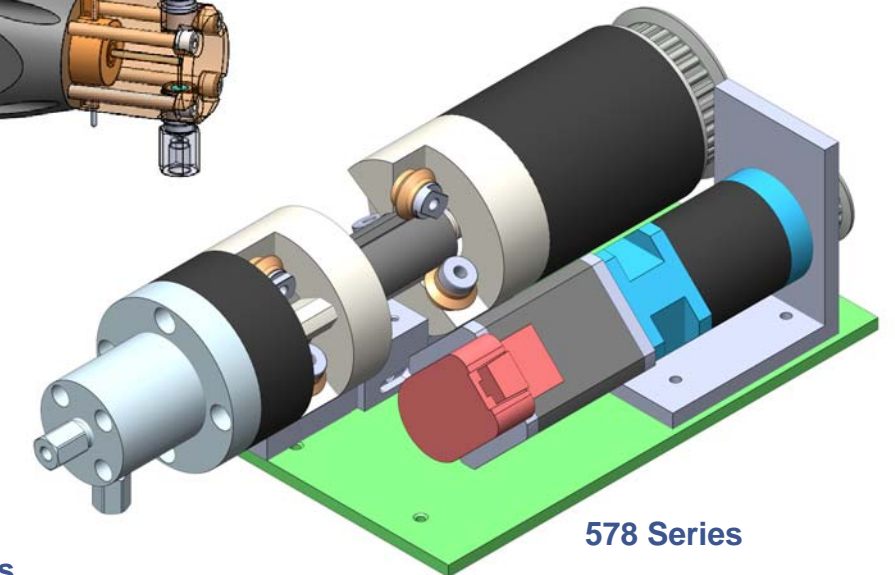

578 Series

Features

- OEM private label for OEMs
- Spring loaded check valves allow operation in horizontal or vertical mounting orientation
- Graphical user interface
- Wash seal option for pumping buffers
- Stepper motor with drive/controller
- Available with HPLC (576 Series) & UHPLC (578 Series)
- Material options including Ultem, PEEK, Teflon or 316SS
- Modbus RTU, RS485 serial communications protocol for OEM software control
- Dual syringe HPLC & UHPLC gradient option
- Nano check valves eliminate need for expensive rotary switching valves. No particulates from worn valves!

ASI

ASI Model 576 Syringe Pumps outperformed competitors in head-to-head engineering trials. Flow precision, was closed as the critical evaluation metric by an independent engineering team. ASI was best-in-class for low flow ($\mu\text{L}/\text{min}.$) for pressures up to 9,000 PSI. Applications requiring such high precision includes: HPLC, LCMS, Sampling systems, Metering liquids and Sample preparation.

Unmatched flow precision at high pressure make the ASI 576 Syringe Pump the top choice for design engineers.

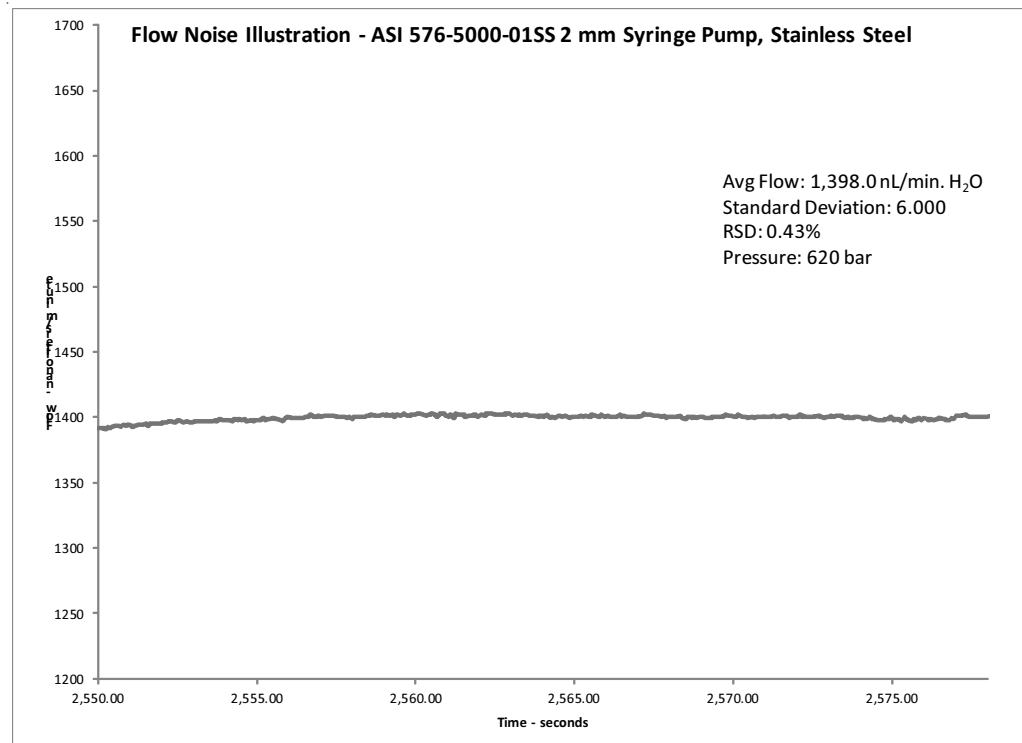
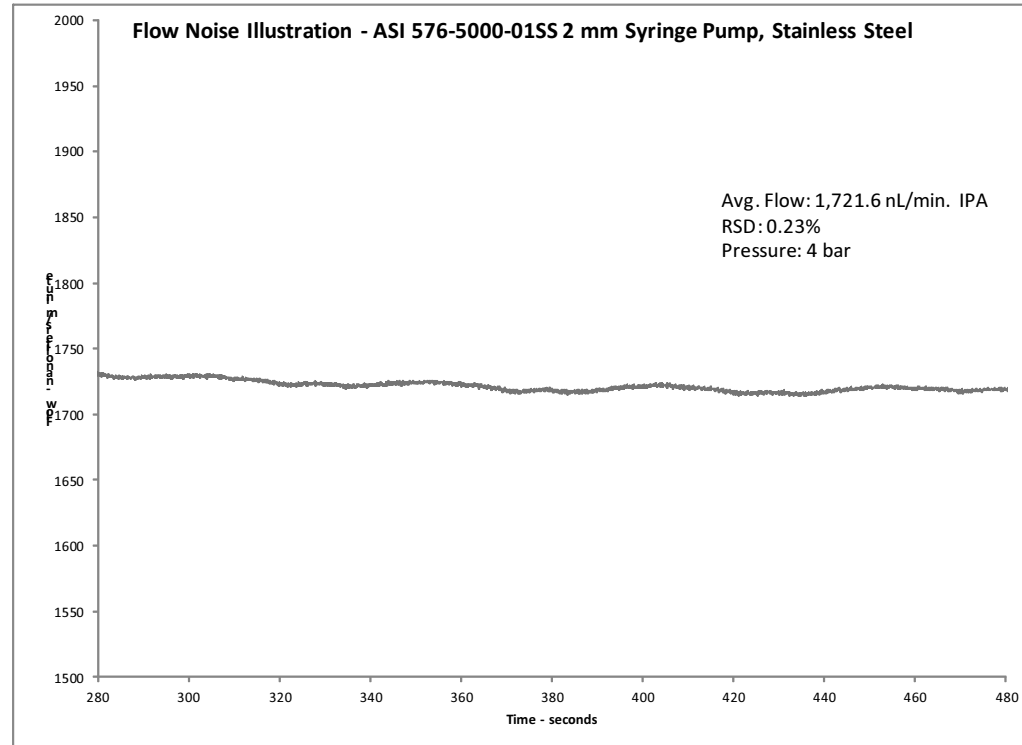

Competitor #1

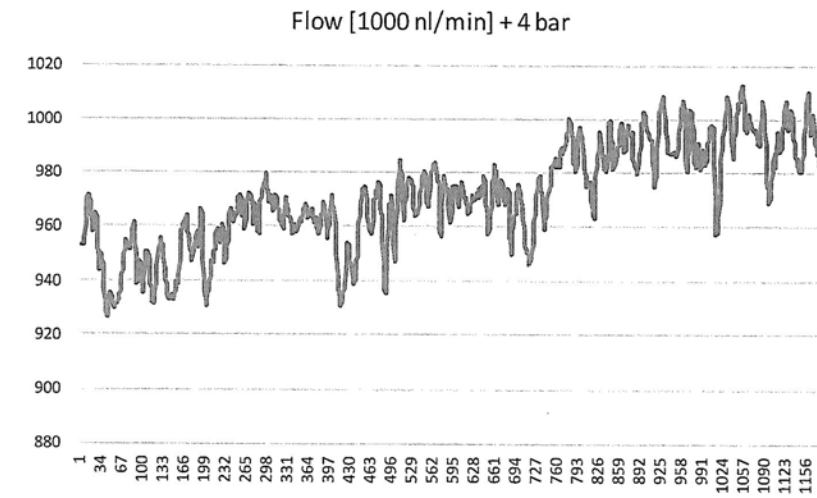

AVR 969,8231
SD 18,80877
RSD% 1,939402

Competitor #2

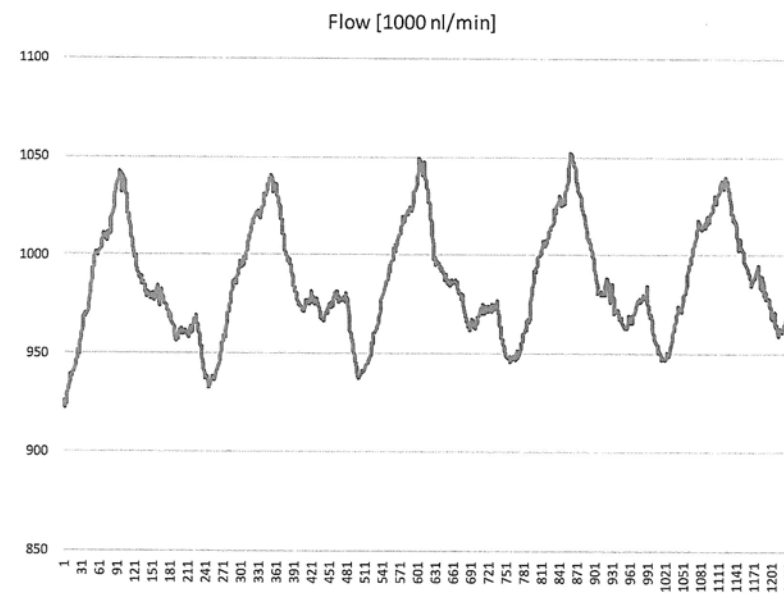

AVR 986,626
SD 28,10129
RSD% 2,848221

Specifications

Motor Description:

NEMA 17 triple stack step motor - pump controller with motor drive & controller

Power:

100 - 240 VAC, 50 - 60 Hz, 1 A Max

OEM Power Option:

24 VDC, 3A Max

Operating Temperature:

4 - 40° C

Dimensions:

13.75" L x 3" W x 4.1" H (with cover)